

This map is reproduced from Ordnance Survey material with the permission of Ordnance Survey on behalf of the Controller of Her Majesty's Stationery Office © Crown copyright. Unauthorised reproduction infringes Crown copyright and may lead to prosecution or civil proceedings. Oxfordshire County Council 0100023343 [2017].

DO NOT SCALE

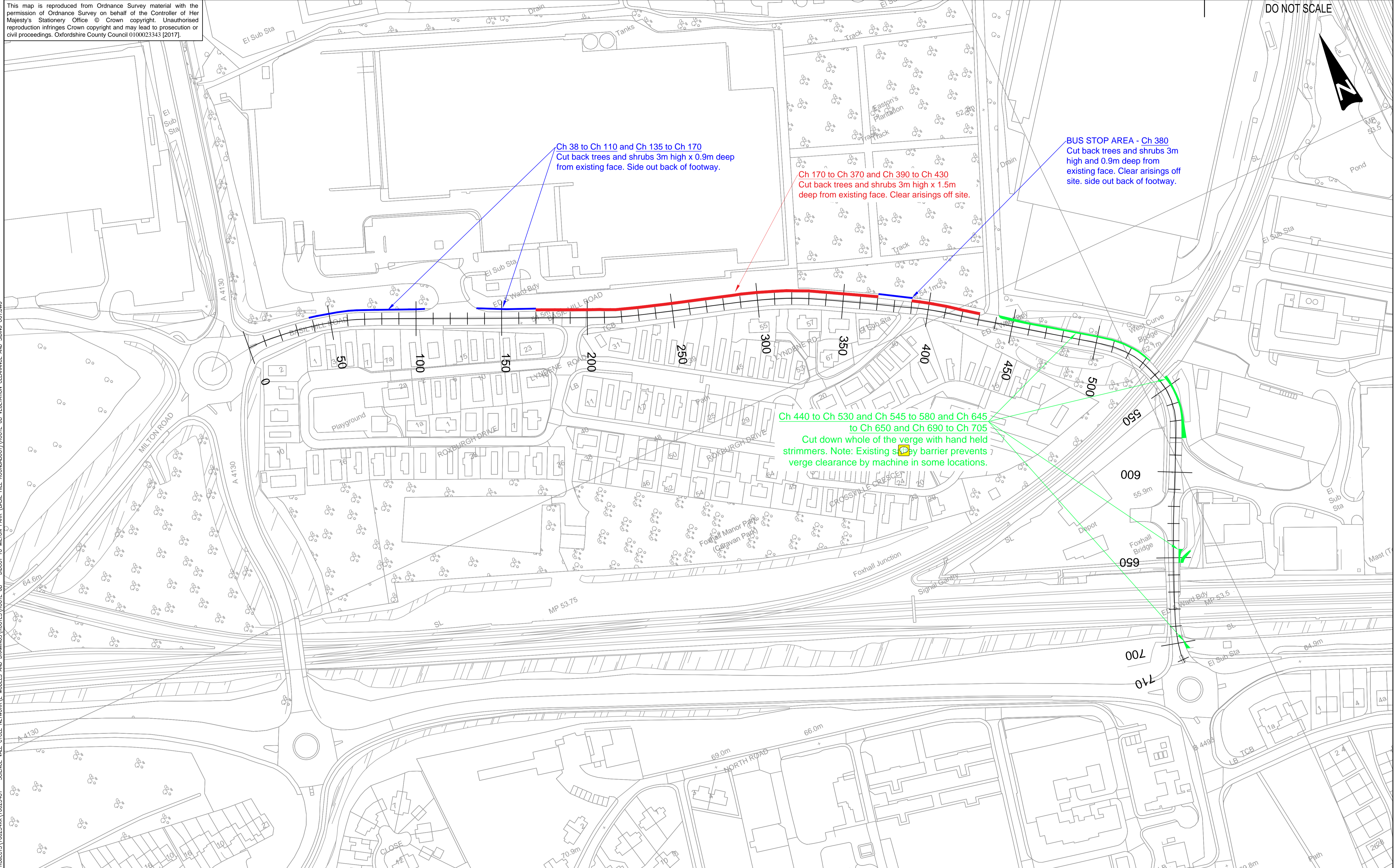

\\uk.wspgroup.com\central\_data\projects\70023481 - SCIENCE WALK CYCLE NETWORK E MODELS AND DRAWINGS\ROUTES\ROUTE 6B - DIBBOT TO MILTON PARK (BASIL HILL ROUNDABOUT)\ROUTE 6B VEGETATION CLEARANCE AND SIDING OUT.DWG



Ch 38 to Ch 110 and Ch 135 to Ch 170  
Cut back trees and shrubs 3m high x 0.9m deep from existing face. Side out back of footway.

Ch 170 to Ch 370 and Ch 390 to Ch 430  
Cut back trees and shrubs 3m high x 1.5m deep from existing face. Clear arisings off site.

BUS STOP AREA - Ch 380  
Cut back trees and shrubs 3m high and 0.9m deep from existing face. Clear arisings off site. side out back of footway.

Ch 440 to Ch 530 and Ch 545 to 580 and Ch 645 to Ch 650 and Ch 690 to Ch 705  
Cut down whole of the verge with hand held trimmers. Note: Existing barrier prevents verge clearance by machine in some locations.

REV	DATE	BY	DESCRIPTION	CHK	APP
A	NOT ISSUED	HP	ISSUED	GN	AW

DRAWING STATUS: ISSUED FOR PRICING

One Queens Drive, Birmingham, B5 4PJ, UK  
T+ 44 (0) 121 352 4700, F+ 44 (0) 121 352 4701  
wsp.com

CLIENT: OXFORDSHIRE COUNTY COUNCIL  
CONTRACTOR: SKANSKA

PROJECT: SVCN ROUTE 6B  
BASIL HILL ROAD

TITLE: VEGETATION CLEARANCE AND SIDING OUT

SCALE @ A1:	1:1000	CHECKED:	GN	APPROVED:	AW
CAD FILE:	Route 6B Vegetation clearance and siding out	DESIGN-DRAWN:	KP	DATE:	01/11/2017
PROJECT No:	70023481	DRAWING No:	RT6B_200_001	REV:	A

© WSP Group Ltd